

## EXCELOCK Electronic Lock System

### Features

- Able to lock or unlock by passing card key over the antenna. The door will be automatically locked after closed
- Able to apply to glass or wooden swinging doors and sliding doors
- Key is applied RFID system. Easy to register and erase the key numbers without operation, optional computers and changing parts
- Able to install the antenna unit inside the cabinet
- Connect all units with plugging connector
- No need of battery by connecting **XL-ECU** with AC adapter
- No need battery for the key. Max. 30 key changes can be registered (2 additional control key can be registered)
- 1 system (1 **XL-ECU**) can connect with 4 lock units and control 8 locks
- Able to expand the lock system and the number of locks by applying **XL-EEU**



### Installation

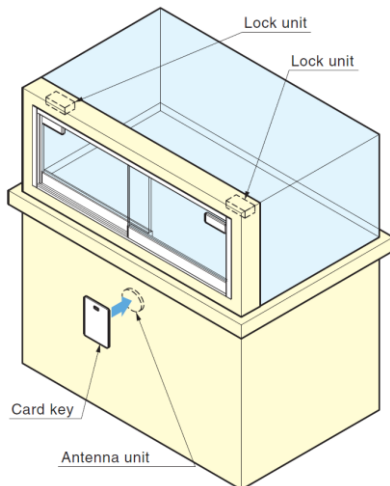

### How to Unlock

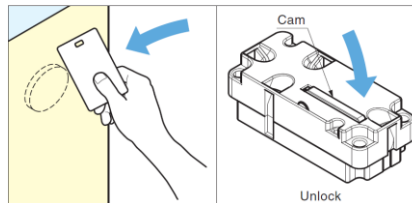

### How to Lock

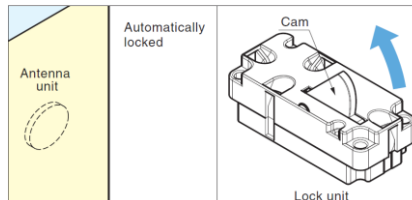

### Manage Multiple Locks

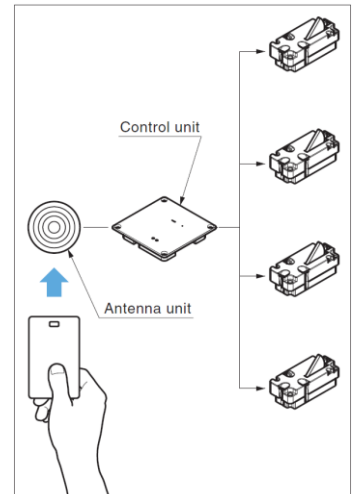

### Installation

① Glass sliding door

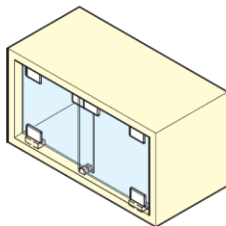

② Glass inset swinging door

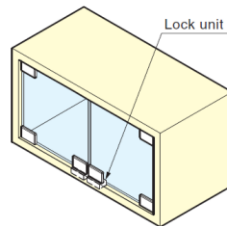

③ Glass overlay swinging door

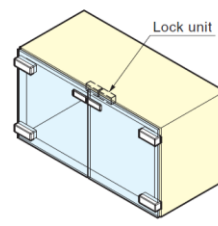

④ Drawer

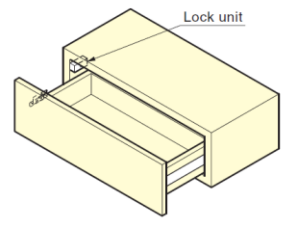

⑤ Glass sliding door

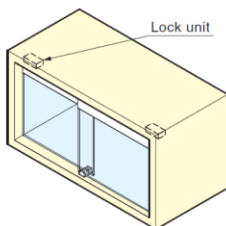

⑥ Glass sliding door

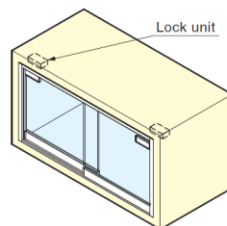

⑦ Wooden sliding door

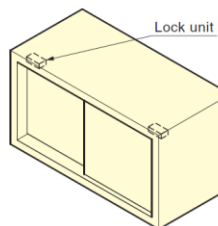

⑧ Wooden overlay door

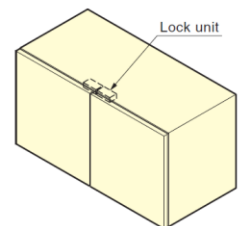

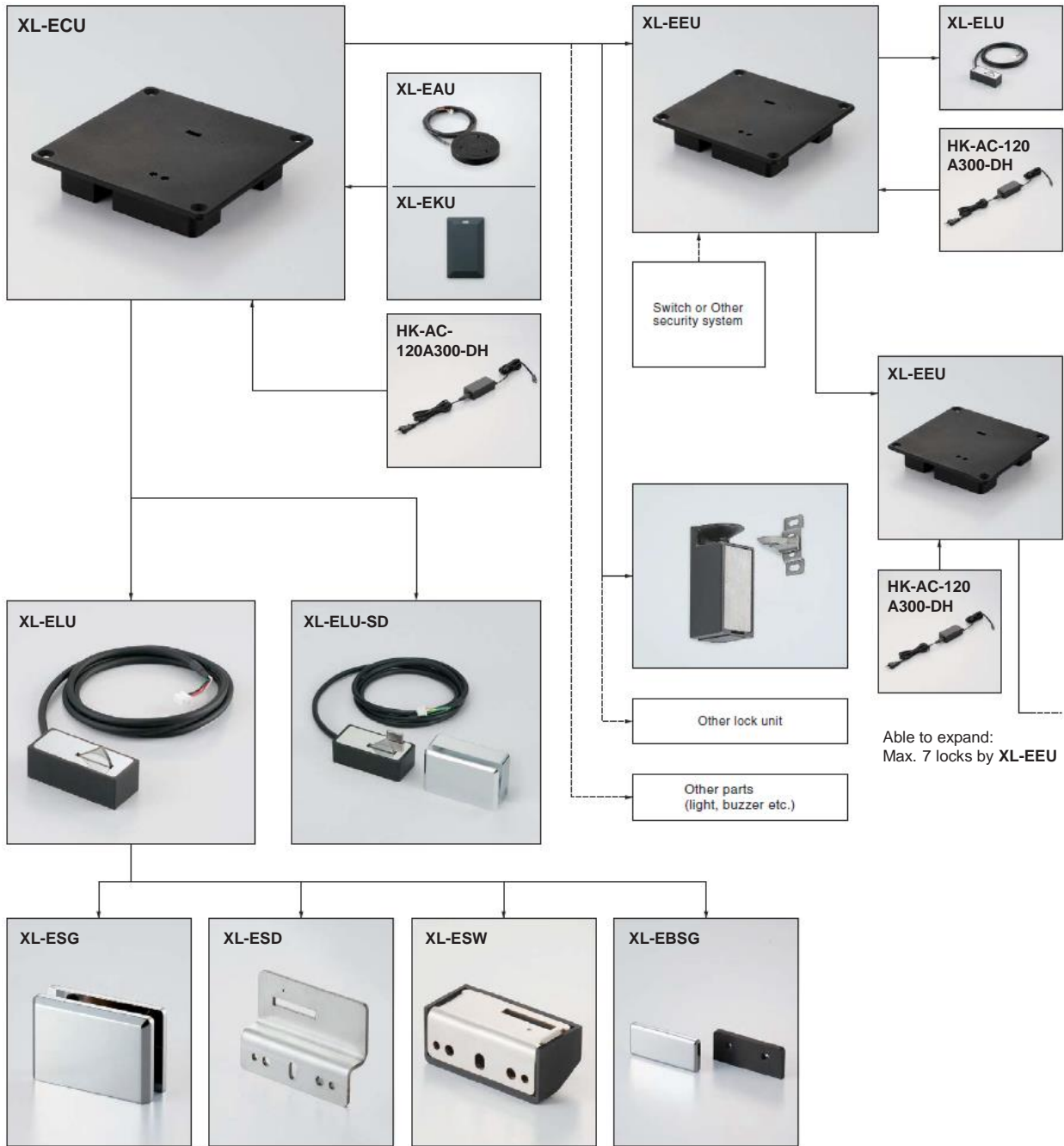

Able to expand:  
Max. 7 locks by XL-EEU

<b>Communication Method</b>		RF-ID 416 kHz
<b>Operating Method</b>		Motor driven
<b>Power Supply</b>		AC adapter
<b>Operating Temperature</b>		0°C - 40°C
<b>Sensing Distance</b>		0 - 30 mm
<b>Electrical Characteristics</b>	<b>Standby Current</b>	20 mA (Unlocked)
	<b>Operating Current</b>	Under 600 mA (Use 4 lock units)
<b>Number of Terminal</b>		4 lock units, 4 other lock units, 1 other parts
<b>Number of Lock Unit Connected</b>	Single application	4 lock units
	Multiple application	
<b>Key Changes Registered</b>		Max. 30 key changes + 2 control key